

Dura-Close® Synchronized Soft-close Slides

USE58-500 Series

Construction & Assembly Specifications

	Slide Length	Total Cabinet Depth	Overall Drawer Length	FRAMELESS	FACE FRAME	
				Min Inside Cabinet Depth	Min Inside Cabinet Depth	Max Inside Cabinet Depth
	USE58-500-12 - (12") drawer					
	12-9/16" 319 mm	15" 381 mm	12" 305 mm	12-5/8" 321 mm	12-7/8" 326 mm	14" 356 mm
	USE58-500-15 - (15") drawer					
	15-5/16" 389 mm	18" 457 mm	15" 381 mm	15-5/8" 397 mm	15-7/8" 403 mm	17" 432 mm
	USE58-500-18 - (18") drawer					
	18-5/16" 465 mm	21" 533 mm	18" 457 mm	18-3/8" 473 mm	18-7/8" 479 mm	20" 508 mm
	USE58-500-21 - (21") drawer					
	21-5/16" 541 mm	24" 610 mm	21" 533 mm	21-5/8" 549 mm	21-7/8" 555 mm	23" 584 mm
	USE58-500-24 - (24") drawer					
	24-5/16" 618 mm	27" 686 mm	24" 610 mm	24-5/8" 625 mm	24-7/8" 632 mm	26" 660 mm

DRAWER BOX MINIMUM WIDTH

5/8" (16 mm) material	8.25"
1/2" (13 mm) material	8"

OUTSIDE DRAWER WIDTH CALCULATIONS

Drawer Side Thickness	Inside Cabinet Width Deduction
5/8"	3/8"
16 mm	10 mm
19/32"	15/32"
15 mm	12 mm
9/16"	9/16"
14 mm	14 mm
1/2"	5/8"
13 mm	16 mm
15/32"	23/32"
12 mm	18 mm

FRONT HOLE PATTERN

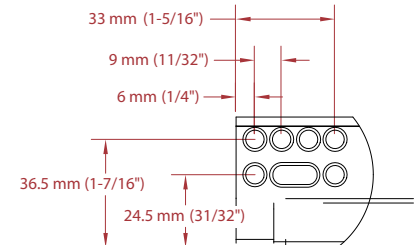

FRONT VIEW OF THE DRAWER INSIDE THE CABINET

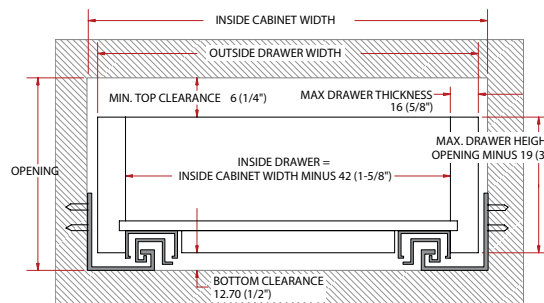

MAXIMUM DRAWER HEIGHT = OPENING MINUS 19 MM (3/4")

Assume 3 mm (1/8") setback from drawer opening

Rear brackets for face frame applications will yield a 5–41 mm (3/16" - 1-5/8") depth adjustment

For inset drawer front applications:

Setback: 4 mm (5/32") + Drawer Front Thickness

For frameless cabinets, Inside Cabinet Depth Minimum = Slide Length + Setback + 3 mm (1/8")

For face frame cabinets, Inside Cabinet Depth Minimum = Slide Length + Setback + 5 mm (3/16")

Inside Cabinet Depth Maximum = Slide Length + Setback + 41 mm (1-5/8")

REAR NOTCH DIMENSIONS

